

# 6300C - PANIC & 6300CF - FIRE LABELED STEEL DOOR - CVR EXIT DEVICE MODELS

## 6300 SERIES EXIT DEVICES USING SNB OR SURFACE MOUNT FASTENERS

TEMPLATE: 639310  
REV. 4 12-27-22

### DEVICE

**MACHINE SCREWS:**  
USE #7 OR 13/64" DRILL AND 1/4-20 TAP

**WOOD SCREWS:**  
USE 5/32" DRILL

**SEX NUTS:**  
USE 3/8" DRILL PULL SIDE  
USE 9/32" DRILL PUSH SIDE

### NOTES:

1. VERIFY PRINTED TO SCALE
2. SEX NUTS MAY BE REQUIRED FOR UNREINFORCED DOORS OR COMPOSITE FIRE DOORS. CONSULT DOOR MANUFACTURER'S RECOMMENDATIONS
3. SEE TRIM TEMPLATE (IF APPLICABLE) FOR RELATED MACHINING DETAILS
4. DIMENSION "X" SIZED FOR DOOR. REFER TO DEVICE INSTRUCTIONS WHEN CUTTING DOWN FOR NARROWER OPENING
5. CHECK PDQ WEBSITE FOR MOST RECENT REVISION WWW.PDQLOCKS.COM
6. MINIMUM STILE WIDTH: 4 1/8"

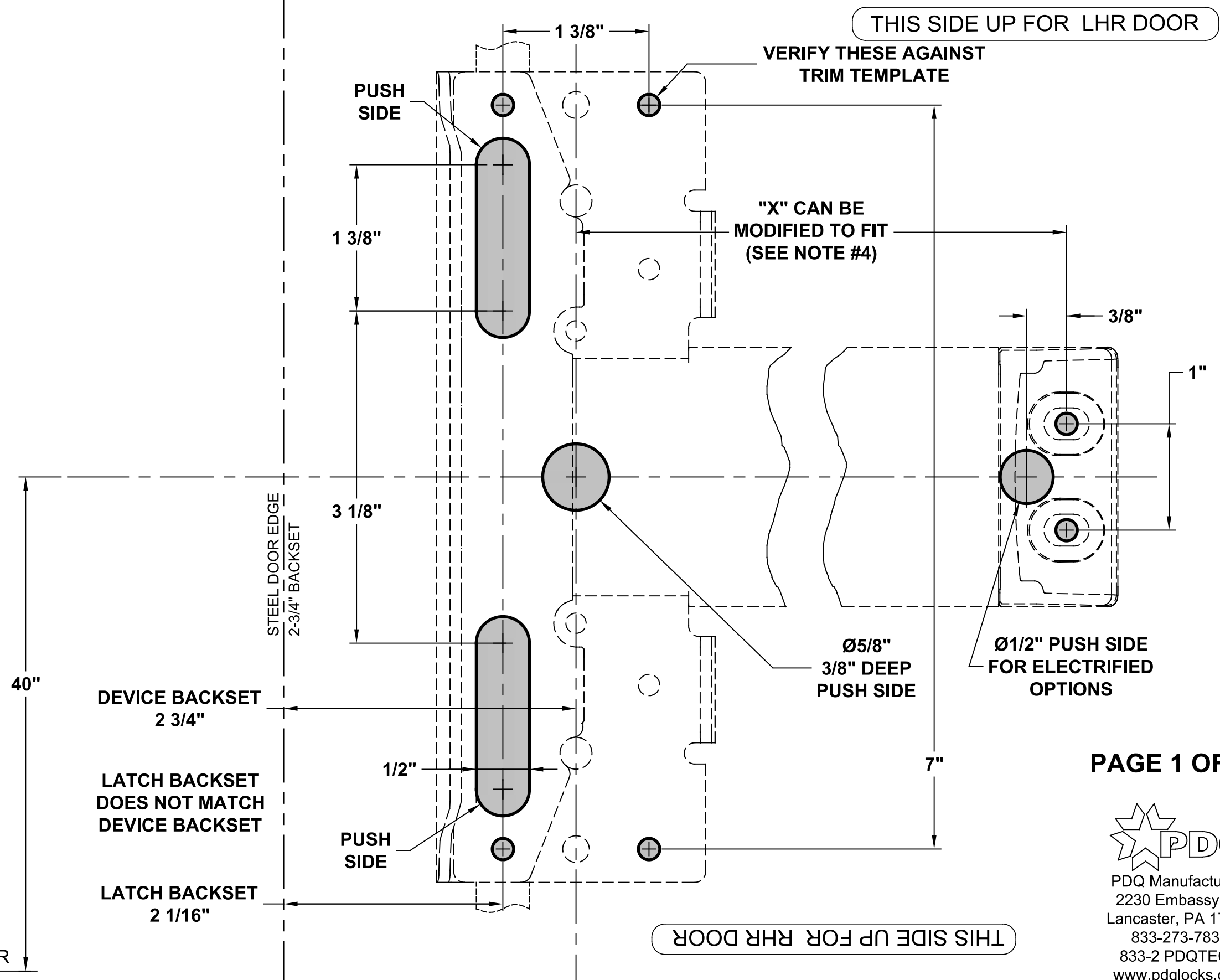

PAGE 1 OF 5



PDQ Manufacturing  
2230 Embassy Dr.  
Lancaster, PA 17603  
833-273-7832  
833-2 PDQTECH  
www.pdqlocks.com

**Typical  
 Top & Bottom  
 Latch**

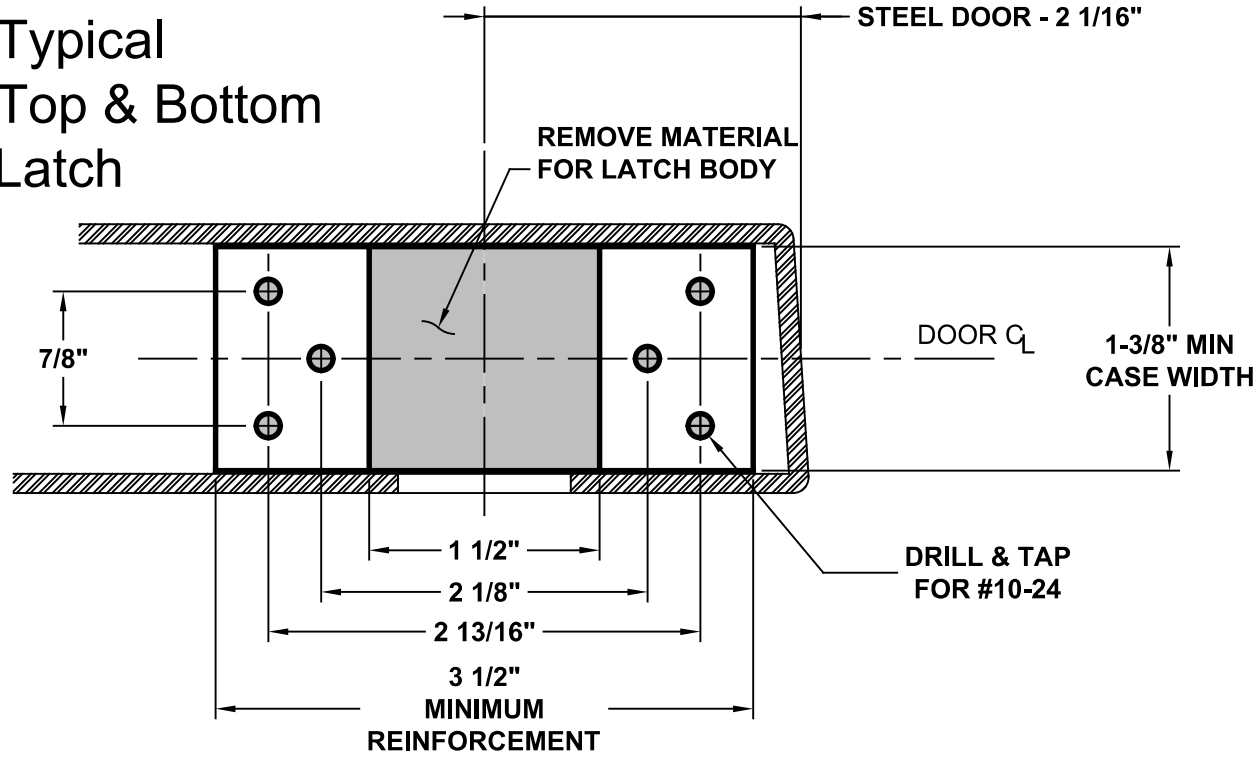

REMOVE MATERIAL  
 FOR STRIKE  
 CLEARANCE

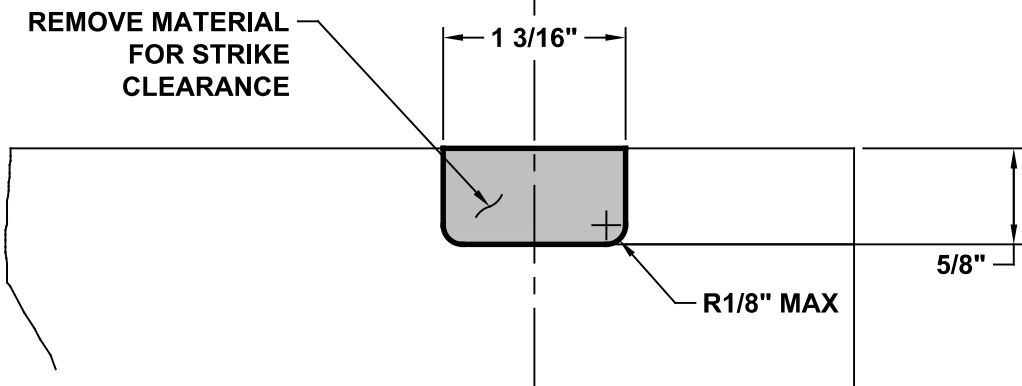

**Top Latch Only -  
 Cut Strike Clearance  
 On Push Side Door Face**

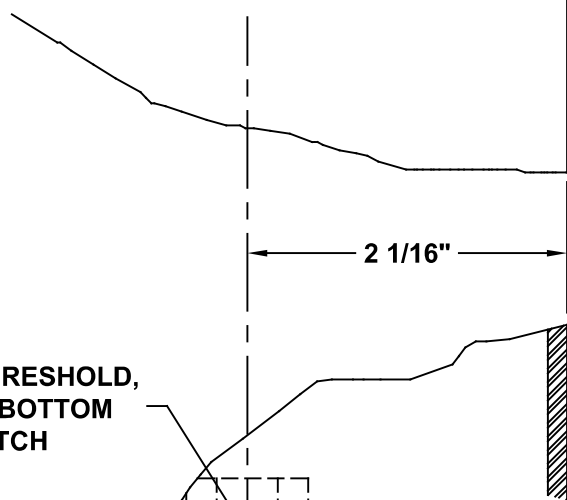

**\*\*FOR DOORS WITH 1/2" THRESHOLD,  
 USE UPPER PIN HOLE IN BOTTOM  
 ROD TO FASTEN LATCH**

**Bottom Latch  
 Door Prep**

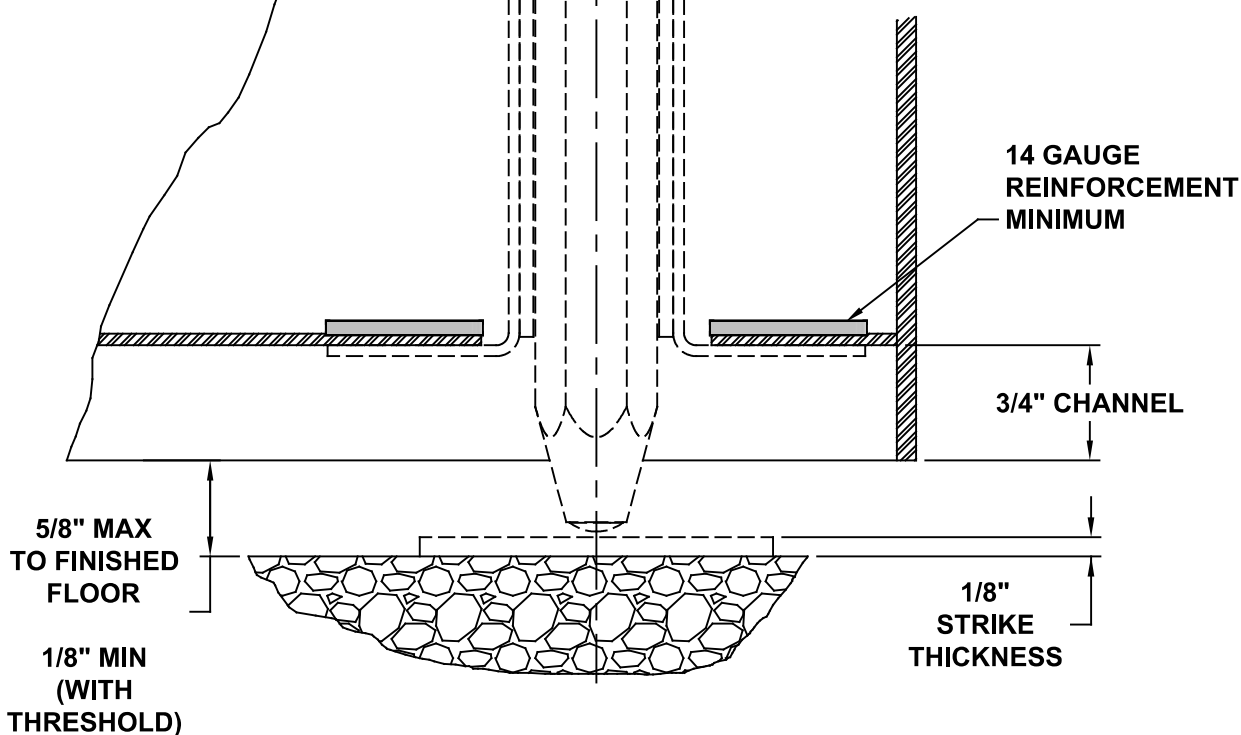

14 GAUGE  
 REINFORCEMENT  
 MINIMUM

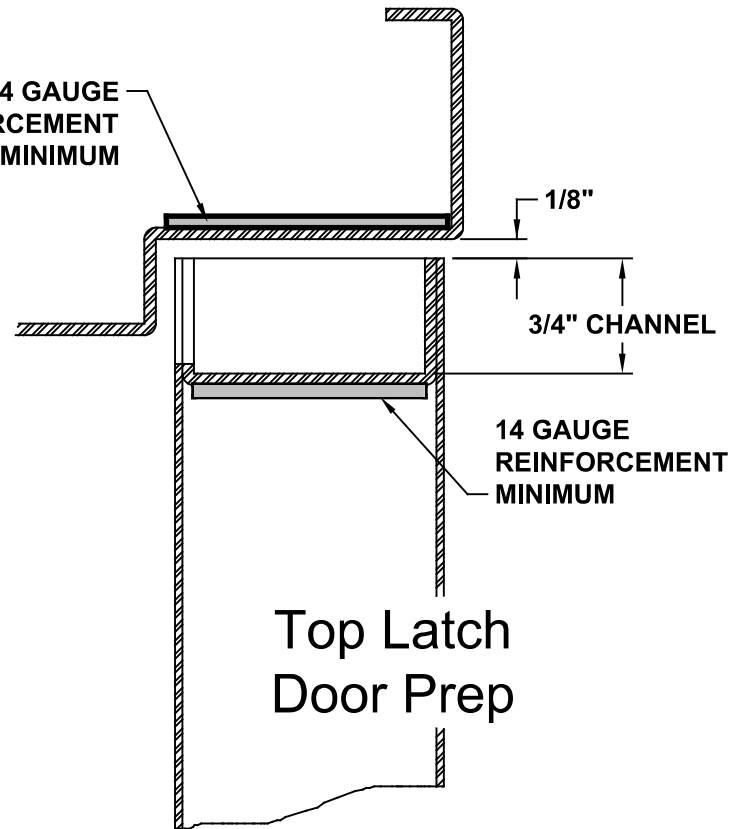

**Top Latch  
 Door Prep**

**NOTES:**

1. THIS PAGE NOT TO SCALE
2. STRIKE REINFORCEMENTS MUST BE MINIMUM 14GA STEEL.
3. BOTTOM LATCH LOCATION ASSUMES TYPICAL 5/8" UNDERCUT.
  - a. BOTTOM OF DOOR TO FINISHED FLOOR TO BE 5/8" MAX.
  - b. MINIMUM 1/8" GAP FROM 1/2" THRESHOLD.
  - c. FOR BOTTOM DOOR GAP UNDER 5/16" OR WITH THRESHOLD, USE UPPER PIN HOLE IN BOTTOM ROD.
4. CHECK PDQ WEBSITE FOR MOST RECENT REVISION [WWW.PDQLOCKS.COM](http://WWW.PDQLOCKS.COM)





# CVR LATCH - ALUMINUM DOOR

FOR 6300 SERIES EXIT DEVICES

TEMPLATE: 639310  
REV. 4 12-27-22

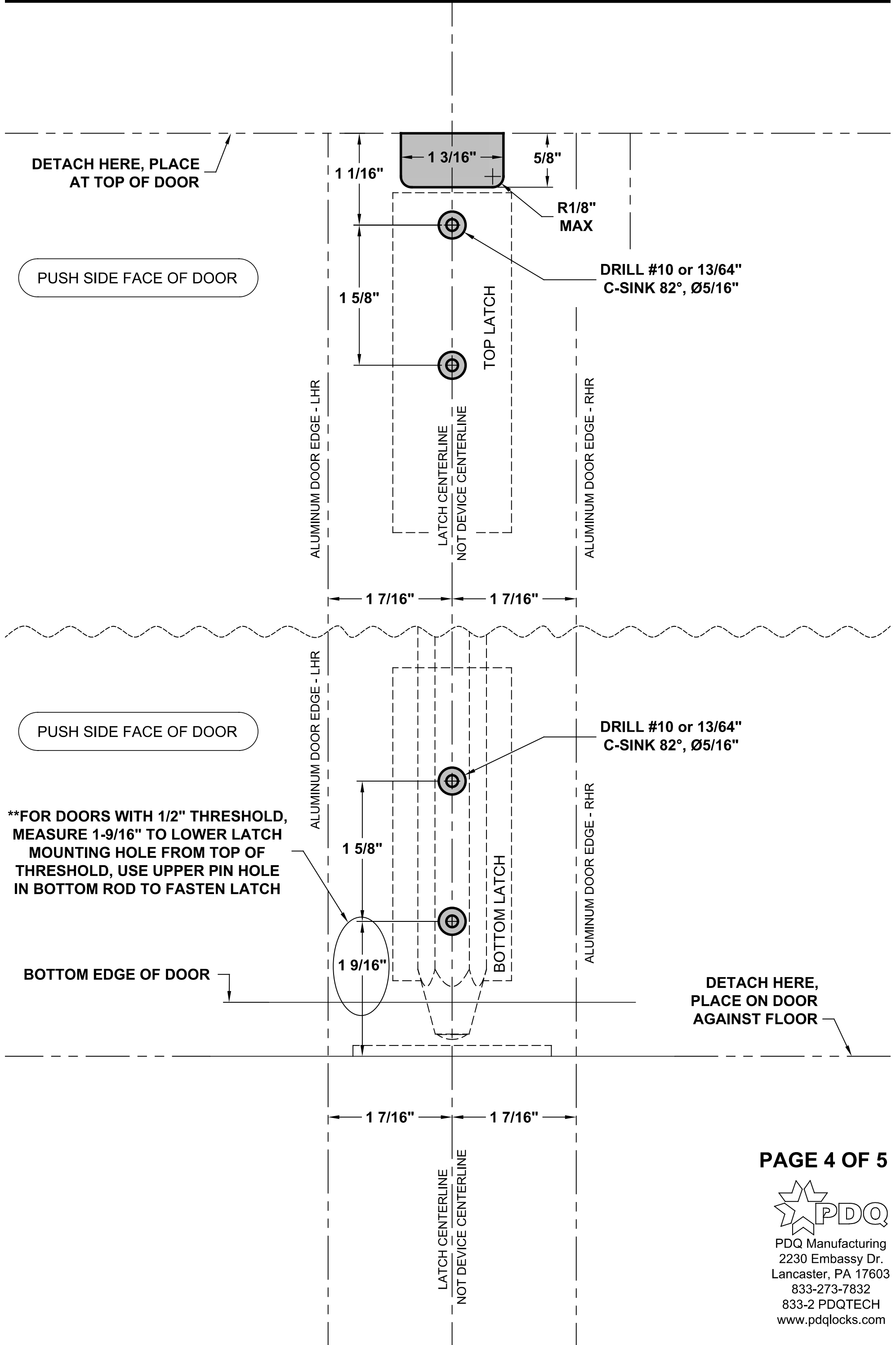

## TOP STRIKE

MACHINE SCREWS:  
USE #25 OR 5/32" DRILL & #10-24 TAP

## Top Strike Frame Prep

CUT TEMPLATE,  
PLACE ON FRAME  
AGAINST DOOR STOP

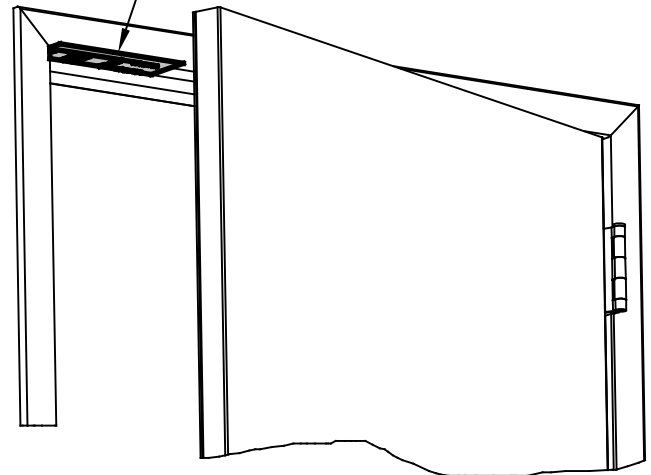

LATCH CENTERLINE

7/16"

DETACH HERE, PLACE  
ABOVE DOOR &  
AGAINST STOP

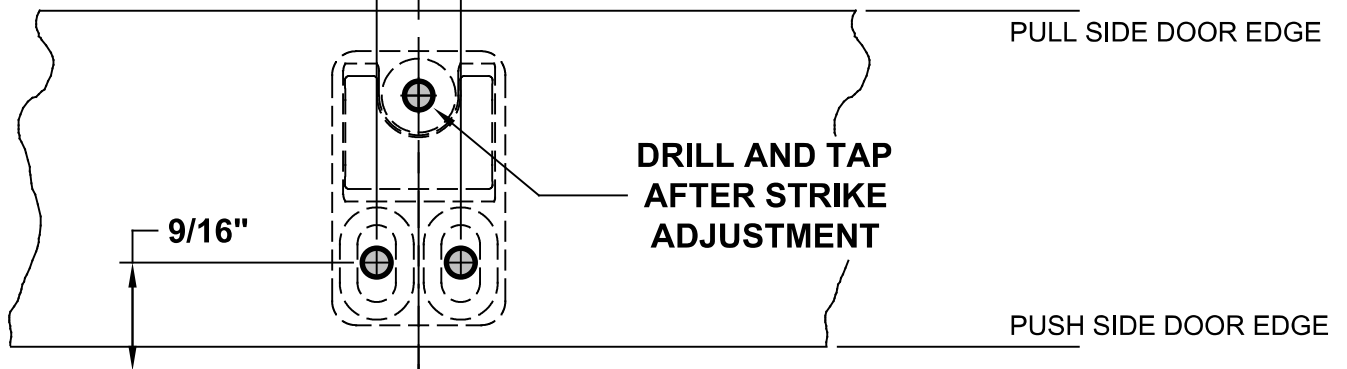

DRILL AND TAP  
AFTER STRIKE  
ADJUSTMENT

PULL SIDE DOOR EDGE

PUSH SIDE DOOR EDGE

9/16"

DETACH HERE &  
PLACE ON FLOOR

PULL SIDE DOOR EDGE

Ø1"  
3/4" DEEP

PUSH SIDE DOOR EDGE

7/8"

1"

Ø1/4  
1" DEEP FOR  
INCLUDED ANCHOR

1 3/4"

## Bottom Strike Floor Prep

LATCH CENTERLINE

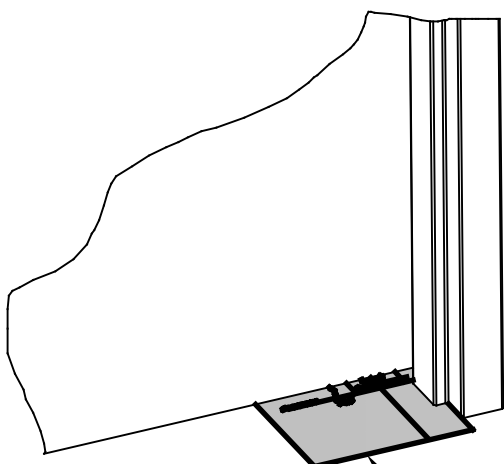

CUT TEMPLATE  
PLACE ON FLOOR  
ALIGNED WITH DOOR

