

**Instructions for Installing AD-8400, MD-8400 & 12-MD-8400 Series Concealed Vertical Rod Exit Device**

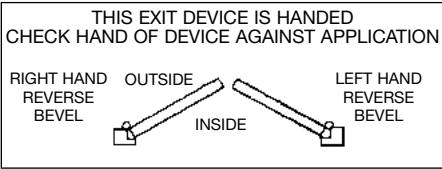

Verify that the correct exit device is being installed on the correct door. Function, finish and size should all be verified. **Note: Before removing door from hinges, determine the gap between top of door and frame. Determine smallest gap between bottom of door and high point of floor or threshold as door swings.** This information is needed for step #7. Remove door from the frame.

- 1) Drill, tap & c'sink the door per template, except for the (2) #10-24 (4A) on the hinge side.

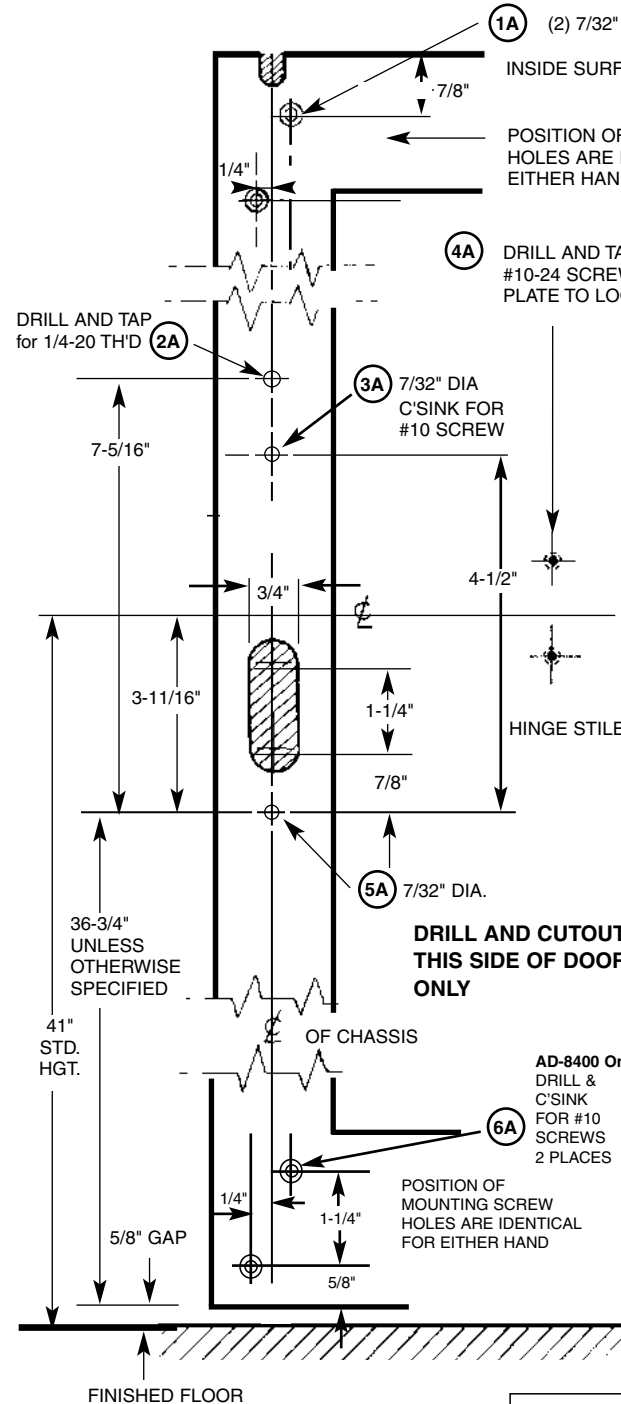

Information for Cutting Rails		
Rail Sizes	Door Widths	
	Max	Min
E	32"	24"
F	36"	33"
J	42"	37"
G	48"	43"

**Door prep shown is the same for both the MD-8400, 12-MD-8400 and AD-8400 Series exit devices, except for attaching the bottom plate or bracket. 12- and MD- is shown separately below.**

**Note: If 100 series auxiliary control is being used, door must be prepped for Aux Control prior to installing device on to the door. Aux Control can be installed after exit device is installed. See appropriate instructions.**

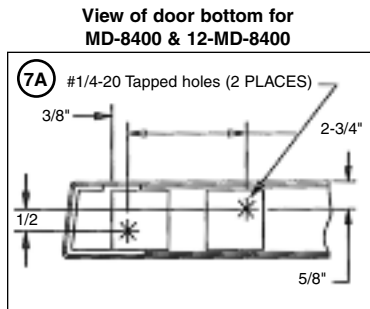

- 2) Screw top bolt & rod assembly (A) and bottom bolt & rod assembly (D) into inner chassis (B).
  - 3) Slide complete assembly into top of door.
  - 4) Attach inner chassis (B) to door with screw (EE) using hole (3A).
- Note: If 700 Series ET Control is being used, it must be installed at this point, prior to step 5. See appropriate instructions.**
- 5) Position chassis (C) over fillister head screw (EE) and attach to inner chassis (B) using hole (5A) with washer (JJ) & screw (HH). Do not tighten yet.
  - 6) Secure top of chassis (C) to door with screw (FF) using tapped hole (2A). Do not tighten yet. Use chassis (C) to retract top bolt & rod assy (A) & bottom bolt & rod assy (D) to adjust bolt projection.

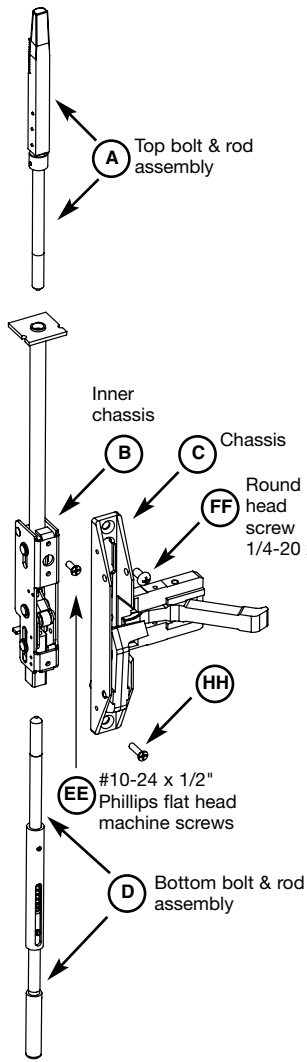

For additional information, contact SARGENT at 1-800-727-5477

- Note: Rods must be retracted while adjusting bolt projection. Use chassis (C) to retract top bolt & rod assy (A) & bottom bolt & rod assy (D)**
- 7A) Adjusting the top bolt & rod assembly**
- 1) 1/8" gap or less between door top and frame. Rotate bolt to make even with top of the door
  - 2) 1/8" gap or greater. Bolt to extend above door equal to gap minus 1/8"
- 7B) Adjusting the bottom bolt & rod assembly**
- 1) 1/8" gap or less between door bottom & high point. Rotate bolt to make even with bottom of door
  - 2) 1/8" gap or greater. Bolt to extend below door equal to gap minus 1/8"

**SCREWS USED FOR AD-8400, MD-8400 AND 12-MD-8400 EXIT DEVICE INSTALLATION**

#8-32 x 3/8" PHILLIPS TRUSS HEAD MACHINE SCREW (2 IN PACK FOR CHASSIS TO RAIL ON ALL DOORS)	#8-32 x 5/16" PHILLIPS OVAL HEAD MACHINE SCREW (4 IN PACK FOR ALL COVERS)	#10-24 x 3/4" END CAP (4 IN PACK FOR END CAP MOUNTING BRACKET)	#10-24 x 3/8" PHILLIPS OVAL HEAD MACHINE SCREW (4 IN PACK FOR TOP AND BOTTOM CASE)
#10-24 x 1/2" PHILLIPS FLAT HEAD MACHINE SCREW	1/4-20 x 1/2" PHILLIPS ROUND HEAD MACHINE SCREW (1 IN PACK FOR TOP OF CHASSIS)	1/4-20 x 1/2" PHILLIPS FLAT HEAD MACHINE SCREW (2 IN PACK FOR BOTTOM PLATE 12-MD8400)	#10-24 x 3/4" PHILLIPS FLAT HEAD MACHINE SCREW (1 IN PACK FOR OUTER CHASSIS TO INNER CHASSIS)
STAR WASHER			

<p><b>STRIKE PACK FOR AD-8400</b></p> <p>640 TOP AND BOTTOM STRIKE</p> <p>STRIKE (2 REQUIRED)</p> <p>#10 X 1/2" PHILLIPS FLAT HEAD MACHINE SCREW (4 IN PACK FOR TOP AND BOTTOM STRIKE)</p>	<p><b>STRIKE PACK FOR MD-8400</b></p> <p>650 TOP AND BOTTOM STRIKE</p> <p>STRIKE (2 REQUIRED)</p> <p>#10 X 1/2" PHILLIPS FLAT HEAD MACHINE SCREW (2 IN PACK FOR TOP STRIKE)</p> <p>#10 X 1-1/4" PHILLIPS FLAT HEAD WOOD SCREW (2 IN PACK FOR BOTTOM STRIKE)</p>	<p><b>STRIKE PACK FOR 12-MD-8400</b></p> <p>650 TOP STRIKE</p> <p>#10-24 X 1/2" PHILLIPS FLAT HEAD MACHINE SCREW (2 IN PACK FOR TOP STRIKE)</p> <p>606 BOTTOM STRIKE</p> <p>MACHINE SCREW AND ANCHOR (2 PIECES)</p>
--	---	---

- 8) Slide rod silencer (G) over top bolt (F) onto rod, followed by top chassis (E). Secure top chassis (E) to door with (2) screws (DD) using holes (1A).
- 9A) **For AD-8400 bottom bolt:** Install bottom plate (N) over bottom bolt (M) and secure with (2) screws (DD) using holes (6A).
- 9B) **For MD-8400 & 12-MD-8400:** Install bottom plate (O) over bottom bolt (M) and secure with (2) screws (GG) using tapped holes (7A).
- 10) Install door into the frame using hinges
- 11) Slide rail assembly (H) onto chassis (C)
- 12) Align holes for screws (AA)
- 13) Level rail
- 14) Locate & mark holes for mounting plate (J) on hinge side. Drill & tap (2) holes (4A).
- 15) Attach mounting plate (J) and secure rail assembly (H) to door with (2) screws (CC).
- 16) Tighten screws (HH) & (FF) to secure chassis (C) to door

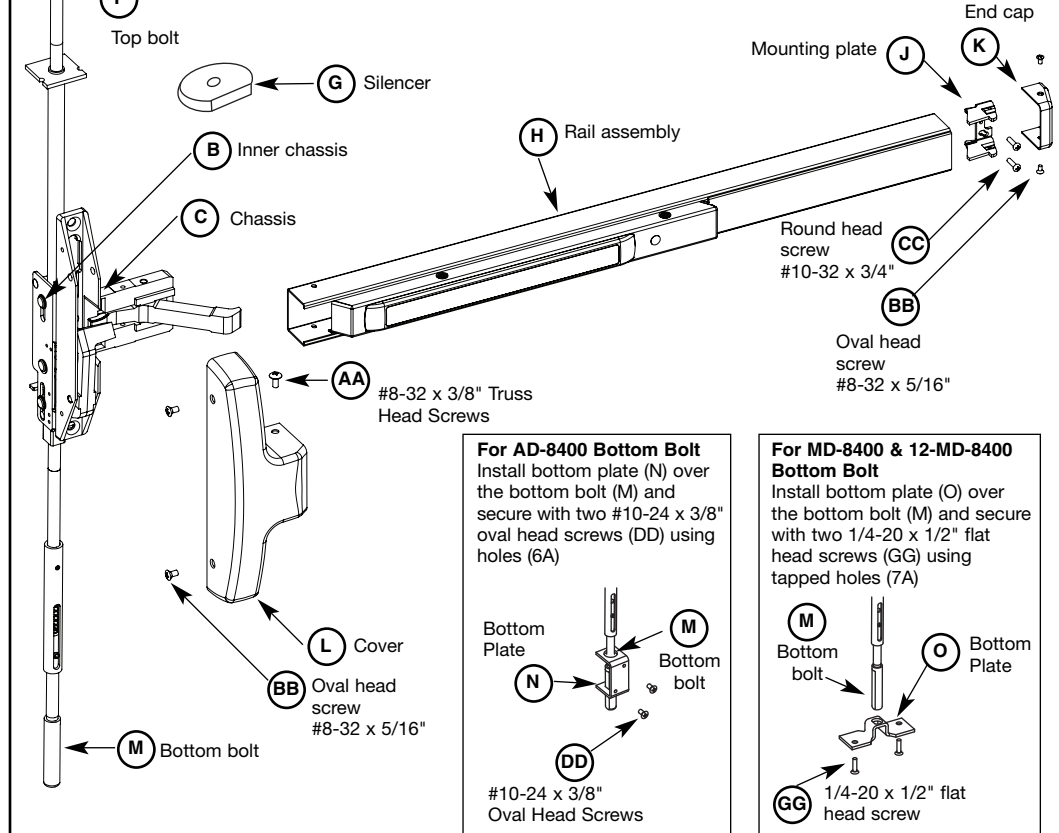

**For AD-8400 Bottom Bolt**  
Install bottom plate (N) over the bottom bolt (M) and secure with two #10-24 x 3/8" oval head screws (DD) using holes (6A)

**For MD-8400 & 12-MD-8400 Bottom Bolt**  
Install bottom plate (O) over the bottom bolt (M) and secure with two 1/4-20 x 1/2" flat head screws (GG) using tapped holes (7A)

- 17) Before closing door, check the following:
  - a) Push rail in to retract bolts
  - b) Bolts stay retracted (hold back)
  - c) Bolts release when door closes. Button inside top of door hits frame
  - d) Bolt engagement with strike 1/4" - 5/16"
  - e) Adjust bolts per steps 7A & 7B)
- 18) **For AD-8400:** Attach 640 strike using instruction sheet A8037 supplied with strike pack.
- 19) **For MD-8400:** Attach 650 top strike to frame with two #10-24 x 1/2" flat head screws & 650 bottom strike with anchors supplied and two #10 x 1-1/4" flat head wood screws. (See chart on left)
- 20) **For 12-MD-8400:** Attach 650 top strike to frame with two #10-24 x 1/2" flat head screws & 606 bottom strikes with anchors supplied and two 1/4-20 x 2" flat head screws. (See chart on left)
- 21) Position cover (L) on chassis (C) and secure with (2) screws (BB)
- 22) Attach end cap (K) to mounting plate (J) with (2) screws (BB)
- 23) Secure rail assembly (H) to chassis (C) and cover (L) with (2) screws (AA)

**Instructions for Installing NB-AD-8400, NB-MD-8400, & 12-NB-MD-8400 Series Concealed Vertical Rod Exit Device**



Verify that the correct exit device is being installed on the correct door. Function, finish and size should all be verified. **Note: Before removing door from hinges, determine the gap between top of door and frame.** This information is needed for step #7. Remove door from the frame.

- 1) Drill, tap & c'sink the door per template, except for the (2) #10-24 (4A) on the hinge side.

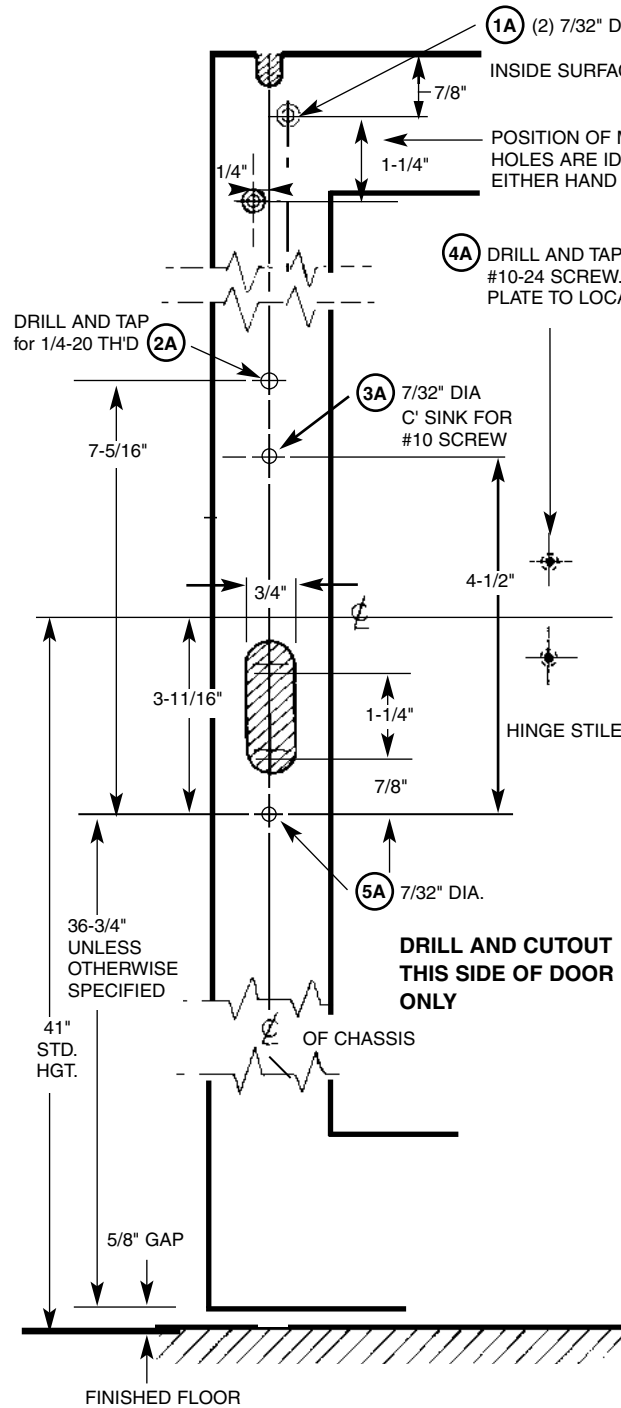

**Door prep shown is the same for all less bottom rod 8400 Exit Devices, except the 12-NB-MD-8400 requires the thermal pin supplied.**

**Note: If 100 Series Auxiliary Control is being used, door must be prepped for Aux Control prior to installing device on to the door. Aux Control can be installed after exit device is installed. See appropriate instructions.**

Information for Cutting Rails		
Rail Sizes	Door Widths	
	Max	Min
E	32"	24"
F	36"	33"
J	42"	37"
G	48"	43"

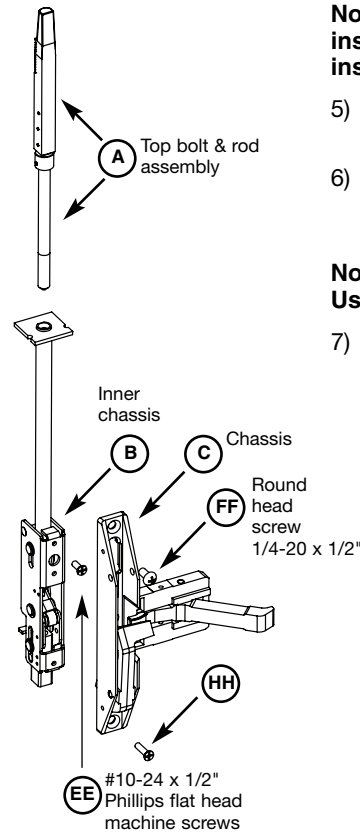
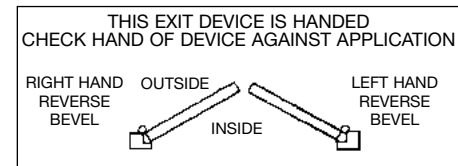

- 2) Screw top bolt & rod assembly (A) into inner chassis (B).
  - 3) Slide complete assembly into top of door.
  - 4) Attach inner chassis (B) to door with screw (EE) using hole (3A).
- Note: If 700 Series ET Control is being used, it must be installed at this point, prior to step 5. See appropriate instructions.**
- 5) Position chassis (C) and attach to inner chassis (B) using hole (5A) with washer (JJ) & screw (HH). Do not tighten yet.
  - 6) Secure top of chassis (C) to door with screw (FF) using tapped hole (2A). Do not tighten yet. Use chassis (C) to retract top bolt & rod assy (A) to adjust bolt projection.

**Note: Rod must be retracted while adjusting bolt projection. Use chassis (C) to retract top bolt & rod assy (A).**

- 7) **Adjusting the top bolt & rod assembly (A):**
  - 1) 1/8" gap or less between door top and frame. Rotate bolt to make even with top of the door
  - 2) 1/8" gap or greater. Bolt to extend above door equal to gap minus 1/8"



For additional information, contact SARGENT® at 1-800-727-5477

**SCREWS USED FOR NB-AD-8400, NB-MD-8400 AND 12-NB-MD-8400 EXIT DEVICE INSTALLATION**

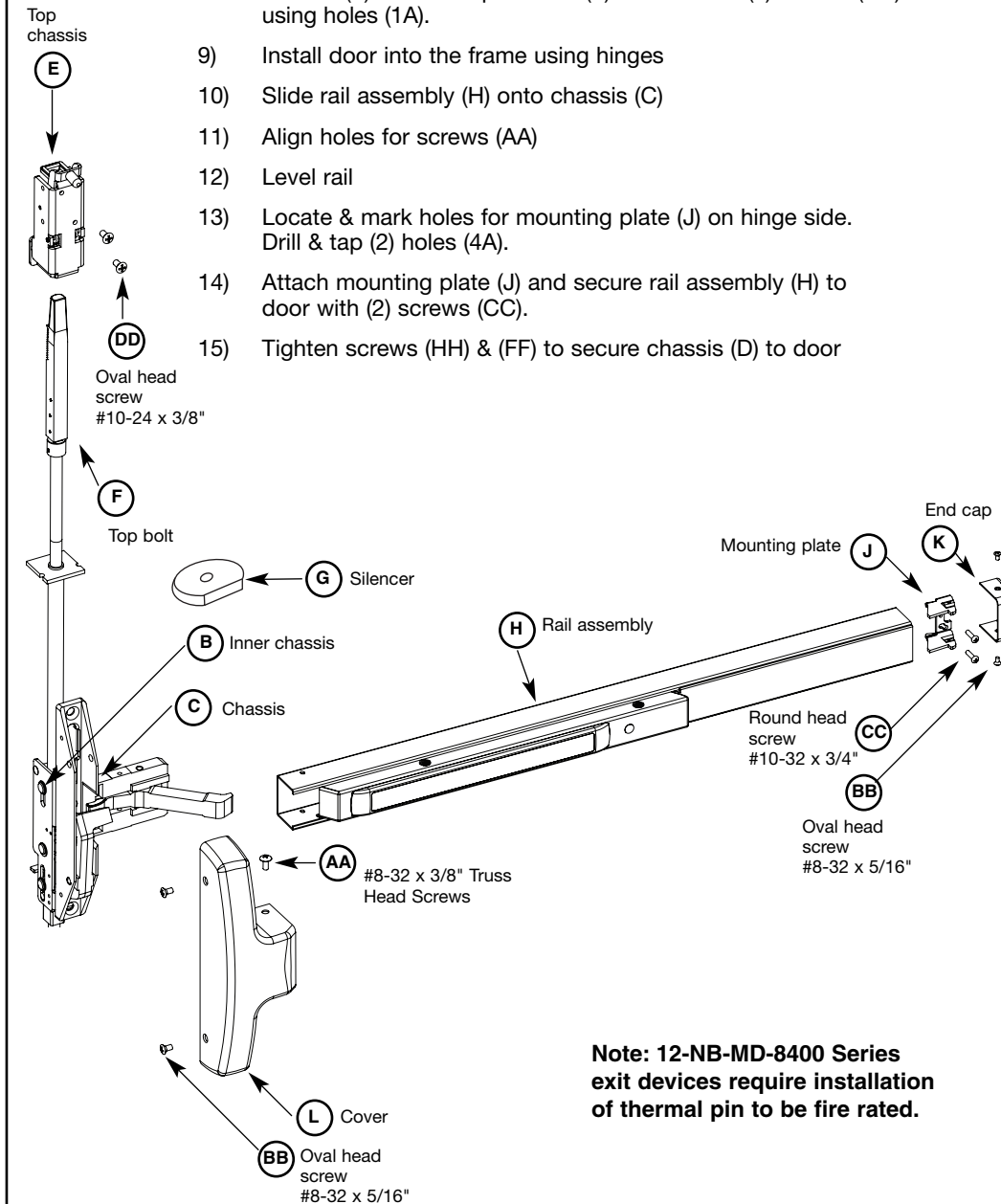
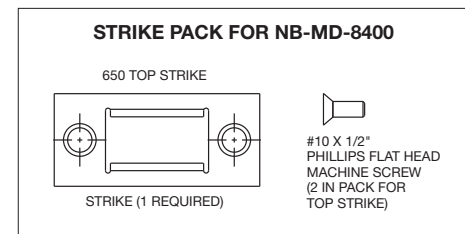
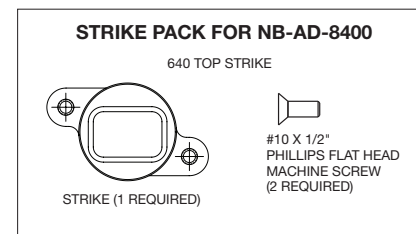
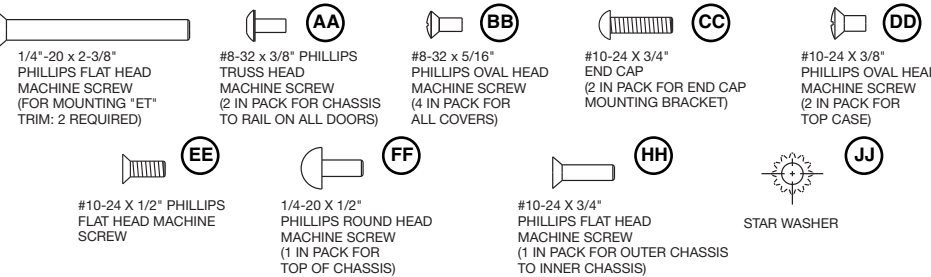

- 8) Slide rod silencer (G) over top bolt (F) onto rod, followed by top chassis (E). Secure top chassis (E) to door with (2) screws (DD) using holes (1A).
- 9) Install door into the frame using hinges
- 10) Slide rail assembly (H) onto chassis (C)
- 11) Align holes for screws (AA)
- 12) Level rail
- 13) Locate & mark holes for mounting plate (J) on hinge side. Drill & tap (2) holes (4A).
- 14) Attach mounting plate (J) and secure rail assembly (H) to door with (2) screws (CC).
- 15) Tighten screws (HH) & (FF) to secure chassis (D) to door

**Note: 12-NB-MD-8400 Series exit devices require installation of thermal pin to be fire rated.**

- 16) Before closing door, check the following:
  - a) Push rail in to retract bolt
  - b) Bolt stays retracted (hold back)
  - c) Bolt releases when door closes. Button inside top of door hits frame
  - d) Bolt engagement with strike 1/4" - 5/16"
  - e) Adjust bolts (per step 7)
- 17) **For NB-AD-8400:** Attach 640 strike using instruction sheet A8037 supplied with strike pack.
- 18) **For NB-MD-8400 and 12-NB-MD-8400:** Attach 650 top strike to frame with two #10-24 x 1/2" flat head screws. See chart on left.
- 19) Position cover (L) on chassis (C) and secure with (2) screws (BB)
- 20) Attach end cap (K) to mounting plate (J) with (2) screws (BB)
- 21) Secure rail assembly (H) to chassis (C) and cover (L) with (2) screws (AA)