

# 45PN & 45PD PULL PLATE INSTRUCTIONS FOR USE WITH 4500 SERIES EXIT DEVICES

## STEP 1: INSTALL CYLINDER (SKIP TO STEP "2" FOR DUMMY PULL PLATE - 45PD)

- INSTALL RIM CYLINDER THROUGH WAVE WASHER, CYLINDER SPACER RING (IF NEEDED) AND COLLAR. THE THINNER COLLAR PROVIDED WITH THE RIM CYLINDER CAN BE USED FOR 1-1/8" LONG CYLINDERS ONLY.
- INSERT RIM CYLINDER THROUGH HOLE IN PULL PLATE AND INSTALL SPACER AND CYLINDER CUP FROM THE BACKSIDE OF THE PULL PLATE.
- SECURE RIM CYLINDER ASSEMBLY USING THE 2 BREAK OFF SCREWS PROVIDED WITH THE RIM CYLINDER.

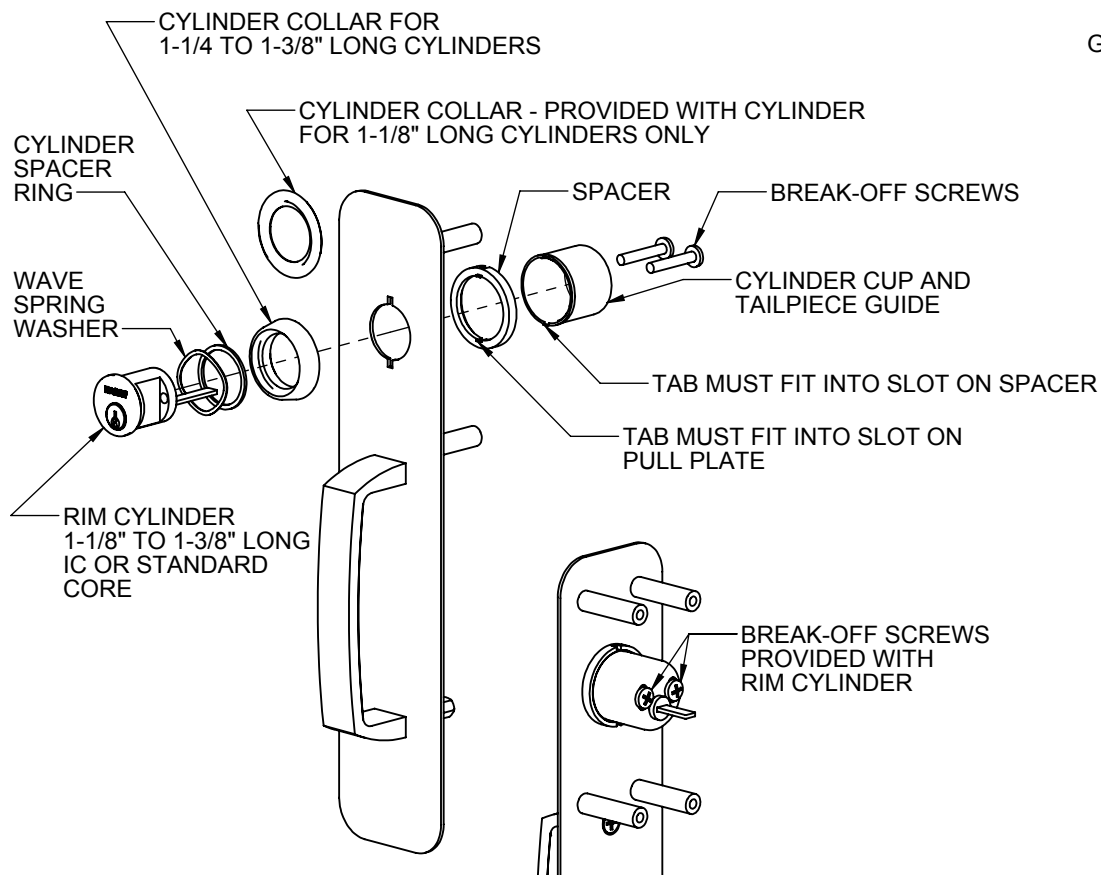

## STEP 2: INSTALL PULL PLATE

- TRANSFER HORIZONTAL CENTERLINE AND BACKSET CENTERLINE FROM EXIT DEVICE SIDE OF THE DOOR.
- USE TEMPLATE OR DIMENSIONS FROM PAGE 2 TO MARK HOLE LOCATIONS.
- DRILL FIVE  $\phi$  1/2" CLEARANCE HOLES FOR MOUNTING POSTS.
- DRILL  $\phi$  1-3/4" CLEARANCE HOLE FOR THE CYLINDER.
- INSERT PULL PLATE MOUNTING POSTS THROUGH DOOR.
- RIM CYLINDER TAILPIECE SHOULD INSERT INTO THE EXIT DEVICE CAM APPROXIMATELY 7/16"  $\pm$  1/16". IF IT'S TOO LONG, CAREFULLY MEASURE AND MARK AT THE CLOSEST BREAK-OFF LINE. THEN USE PLIERS TO BREAK-OFF ACCESS, CAREFULLY NOT TO BREAK-OFF TOO MUCH.
- SECURE PULL PLATE AND EXIT DEVICE USING THE 5 MOUNTING SCREWS.

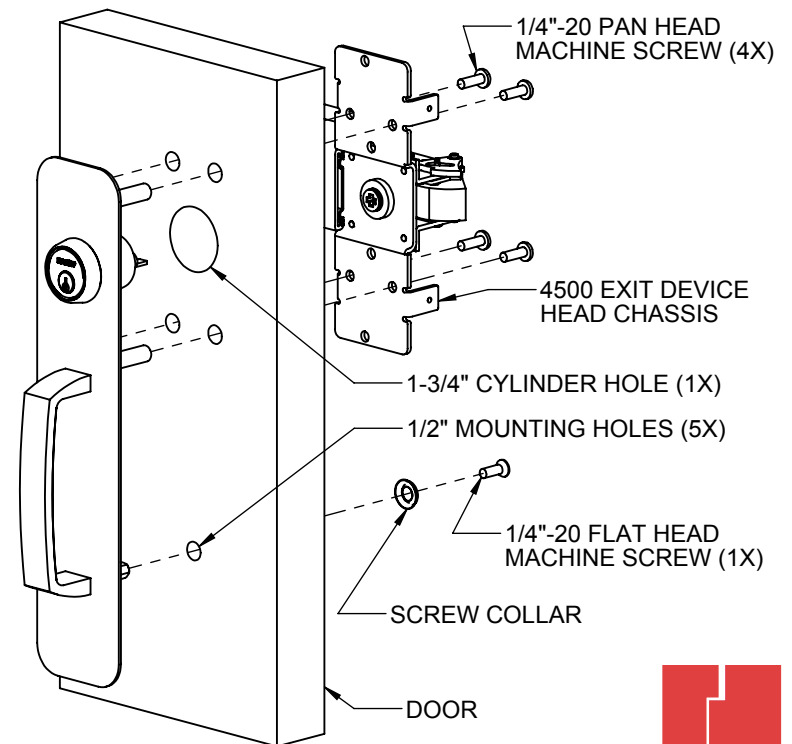

# 45PN & 45PD PULL PLATE INSTRUCTIONS FOR USE WITH 4500 SERIES EXIT DEVICES

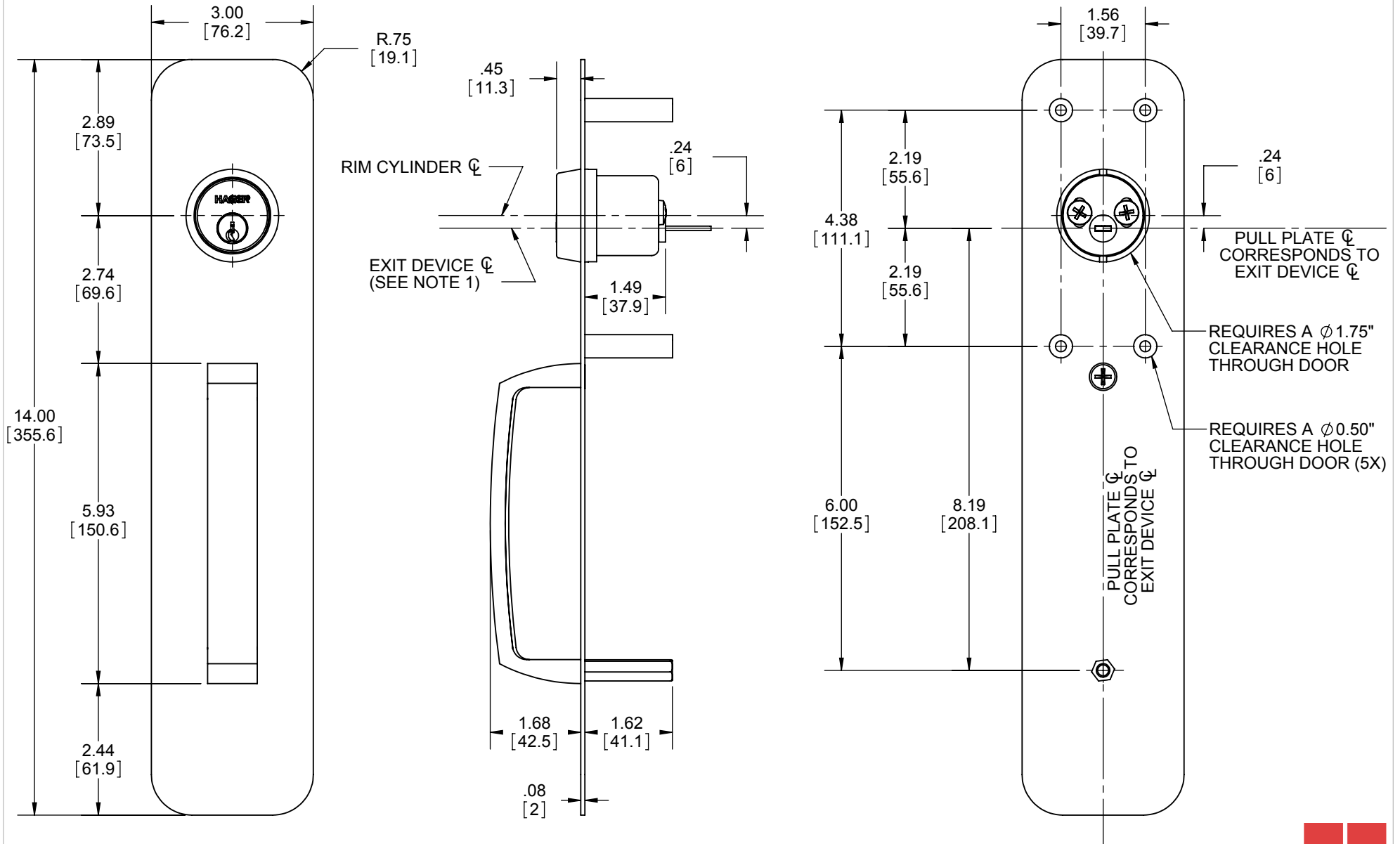

**NOTES:**

1. MATCH THIS CENTERLINE UP WITH THE EXIT DEVICE CENTERLINE. THIS WILL ENSURE THE RIM CYLINDER TAILPIECE LINES UP WITH THE EXIT DEVICE TAILPIECE CAM.

