

ACCENTRA

ASSA ABLOY

nexTouch®
Exit Trim Lock
For Von Duprin
98/99, XP98/99, 98/9927
Exit Device

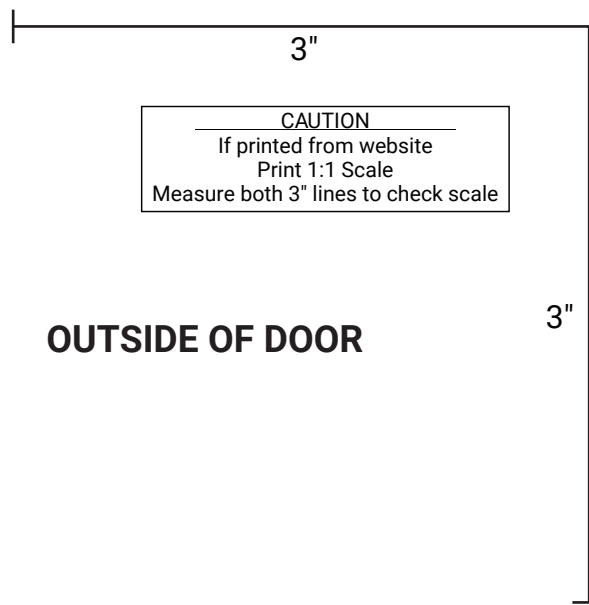

OUTSIDE OF DOOR

NOTES:

1. This door marker is for Von Duprin 98/99, XP98/99, 98/9927 Exit Device.
2. Apply to outside face of door using knockout windows to locate centerlines.
3. If door thickness is other than 1-3/4", or backset is other than 2-3/4", do not place on edge. Find backset by measuring from the centerline of beveled edge.
4. Dimensions given in inches (millimeters).

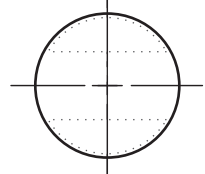
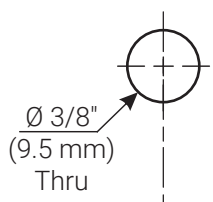

Ø 1/8" (3 mm) Pilot Hole
INSIDE ONLY
(2 Places)
Wood Door: 1/2" (13 mm) Deep
Metal Door: Inside Only

Trim

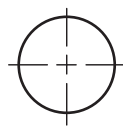
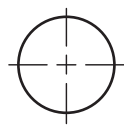

**DRAW CENTERLINE ON 2-3/4" (70 mm) BACKSET
(MEASURED FROM CENTERLINE OF DOOR EDGE BEVEL)
SEE NOTE 3.**

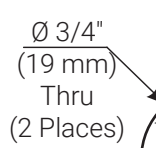

Pushbar
and Lock

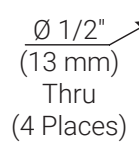

Experience a safer
and more open world

Product Support Tel 800-810-9473 • www.accentra-assaabloy.com

Copyright © 2019, 2024, ASSA ABLOY ACCENTRA™ Access and Egress Hardware Group, Inc. All rights reserved. Reproduction in whole or in part without the express written permission of ASSA ABLOY Access and Egress Hardware Group, Inc. is prohibited.

80-8150-0053-999
Rev B